

eLINE Mounting and overall dimensions

Foot-C face-mounted NEMA-Frames

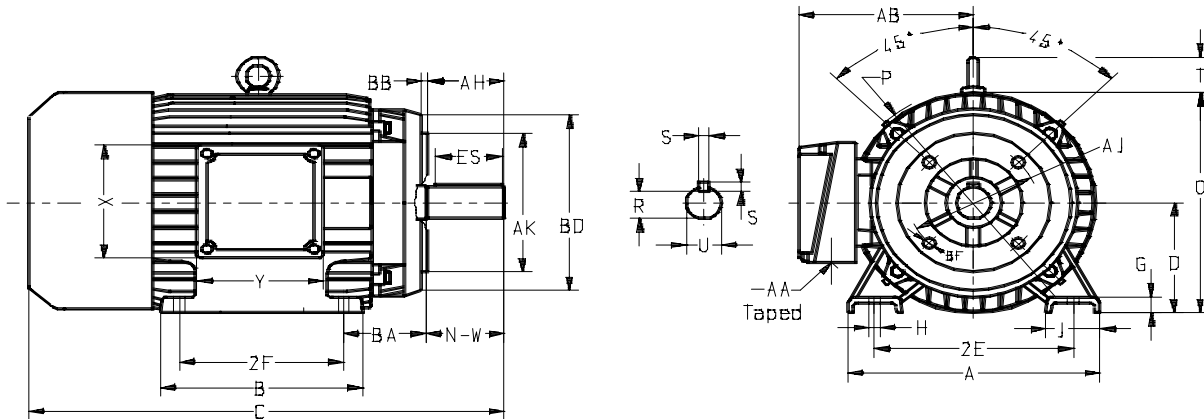

Frame	Mounting dimensions (inches)															
	A	B	D	2E	2F	H	R	S	U	AH	AJ	AK	BA	BB	BD	ES
143TC	6.62	5.83	3.50	5.50	4.00	0.34	0.771	0.188	0.875	2.12	5.875	4.50	2.75	0.16	6.50	1.52
145TC	6.62	7.00	3.50	5.50	5.00	0.34	0.771	0.188	0.875	2.12	5.875	4.50	2.75	0.16	6.50	1.52
182TC	9.00	6.74	4.50	7.50	4.51	0.41	0.986	0.250	1.125	2.62	7.250	8.50	3.50	0.25	8.90	1.94
184TC	9.00	8.31	4.50	7.50	5.51	0.41	0.986	0.250	1.125	2.62	7.250	8.50	3.50	0.25	8.90	1.94
213TC	10.24	8.10	5.25	8.50	5.50	0.41	1.201	0.312	1.375	3.12	7.250	8.50	4.25	0.25	8.90	2.55
215TC	10.24	9.60	5.25	8.50	7.00	0.41	1.201	0.312	1.375	3.12	7.250	8.50	4.25	0.25	8.90	2.55
254TC	12.28	9.92	6.25	10.00	8.25	0.55	1.416	0.375	1.625	3.75	7.250	8.50	4.75	0.25	10.00	3.11
256TC	12.28	11.65	6.25	10.00	10.00	0.55	1.416	0.375	1.625	3.75	7.250	8.50	4.75	0.25	10.00	3.11
284TC	13.78	11.61	7.00	11.00	9.50	0.55	1.591	0.500	1.875	4.38	9.000	10.50	4.75	0.25	11.25	3.53
284TSC	13.78	11.61	7.00	11.00	9.50	0.55	1.416	0.375	1.625	3.00	9.000	10.50	4.75	0.25	11.25	2.10
286TC	13.78	13.11	7.00	11.00	11.00	0.55	1.591	0.500	1.875	4.38	9.000	10.50	4.75	0.25	11.25	3.53
286TSC	13.78	13.11	7.00	11.00	11.00	0.55	1.416	0.375	1.625	3.00	9.000	10.50	4.75	0.25	11.25	2.10

Frame	Overall dimensions (inches)												
	C	G	J	O	P	T	N-W	AA	AB	TAP	X	Y	Bearing No
143TC	13.70	0.39	1.66	7.48	8.27	-	2.25	0.75	5.91	3/8/2016	3.78	3.78	6205 2Z
145TC	14.88	0.39	1.66	7.48	8.27	-	2.25	0.75	5.91	3/8/2016	3.78	3.78	6205 2Z
182TC	15.85	0.60	2.13	9.09	9.53	1.77	2.75	1.00	7.90	1/2/2013	5	5	6306 2Z
184TC	17.46	0.60	2.13	9.09	9.53	1.77	2.75	1.00	7.90	1/2/2013	5	5	6306 2Z
213TC	19.52	0.72	2.20	10.55	10.94	1.77	3.38	1.00	8.45	1/2/2013	5	5	6308 2Z
215TC	21.42	0.72	2.20	10.55	10.94	1.77	3.38	1.00	8.45	1/2/2013	5	5	6308 2Z
254TC	24.60	0.58	2.36	13.18	14.17	2.08	4.00	1.25	10.08	1/2/2013	5.55	5.16	6309 2Z
256TC	26.33	0.58	2.36	13.18	14.17	2.08	4.00	1.25	10.08	1/2/2013	5.55	5.16	6309 2Z
284TC	27.10	0.89	2.75	14.01	14.17	2.08	4.62	1.50	10.34	1/2/2013	5.55	5.16	6311 2Z
284TSC	25.70	0.89	2.75	14.01	14.17	2.08	3.25	1.50	10.34	1/2/2013	5.55	5.16	6311 2Z
286TC	28.60	0.89	2.75	14.01	14.17	2.08	4.62	1.50	10.34	1/2/2013	5.55	5.16	6311 2Z
286TSC	27.20	0.89	2.75	14.01	14.17	2.08	3.25	1.50	10.34	1/2/2013	5.55	5.16	6311 2Z